

**BUILDING SIGN LOCATIONS**  
 NOT TO SCALE  
 JOHNSON  
 LINK  
 WITTENBORG  
 MOONEY  
 HYMAN  
 CROWE  
 NASH

NOTE: SEE DETAILS 1 & 2/A-3 FOR SIGN DETAILS. REFER TO EXISTING SIGN @ DUNN BUILDING, 875 UNION AVENUE FOR SIGN CONSTRUCTION

DOUBLE-SIDED TYPICAL BUILDING SIGN (8'-6" LONG)  
 HYMAN ADMINISTRATION BUILDING  
 62 SOUTH DUNLAP STREET

DOUBLE-SIDED TYPICAL BUILDING SIGN (8'-6" LONG)  
 JOHNSON BUILDING  
 847 MONROE AVENUE

SINGLE-SIDED SMALL BUILDING SIGN (6' LONG?) IN RAISED PLANTER  
 LINK BUILDING  
 855 MONROE AVENUE

SINGLE-SIDED TYPICAL BUILDING SIGN (8'-6" LONG)  
 WITTENBORG BUILDING  
 875 MONROE AVENUE

SINGLE-SIDED TYPICAL BUILDING SIGN (8'-6" LONG)  
 MOONEY BUILDING  
 875 MONROE AVENUE

ANGLED SINGLE-SIDED TYPICAL BUILDING SIGN (8'-6" LONG)  
 CROWE RESEARCH BUILDING  
 874 UNION AVENUE

ANGLED SINGLE-SIDED TYPICAL BUILDING SIGN (8'-6" LONG)  
 CROWE RESEARCH BUILDING  
 874 UNION AVENUE

DOUBLE-SIDED TYPICAL BUILDING SIGN (8'-6" LONG)  
 NASH RESEARCH BUILDING  
 894 UNION AVENUE

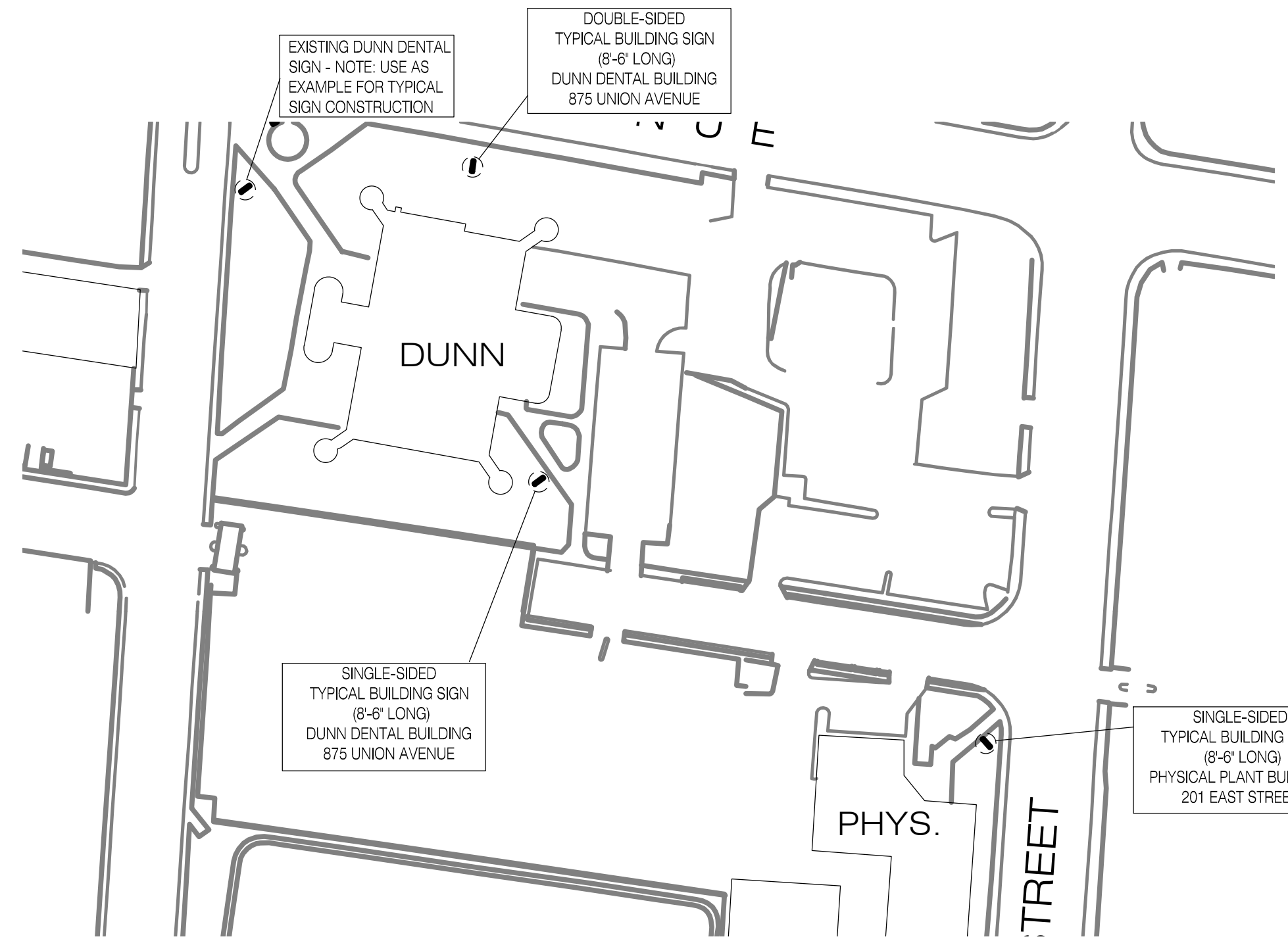

**BUILDING SIGN LOCATIONS**  
 NOT TO SCALE  
 DUNN  
 PHYSICAL PLANT

NOTE: SEE DETAILS 1 & 2/A-3 FOR SIGN DETAILS. REFER TO EXISTING SIGN @ DUNN BUILDING, 875 UNION AVENUE FOR SIGN CONSTRUCTION

EXISTING DUNN DENTAL SIGN - NOTE: USE AS EXAMPLE FOR TYPICAL SIGN CONSTRUCTION

DOUBLE-SIDED TYPICAL BUILDING SIGN (8'-6" LONG)  
 DUNN DENTAL BUILDING  
 875 UNION AVENUE

SINGLE-SIDED TYPICAL BUILDING SIGN (8'-6" LONG)  
 DUNN DENTAL BUILDING  
 875 UNION AVENUE

SINGLE-SIDED TYPICAL BUILDING SIGN (8'-6" LONG)  
 PHYSICAL PLANT BUILDING  
 201 EAST STREET

**THE UNIVERSITY of TENNESSEE**  
 Health Science Center  
**Office of Architecture and Planning**  
 201 East Street · Memphis, Tennessee 38163  
 Voice Phone (901) 448-5503 · Fax Phone (901) 448-7735

SEAL

REVISION:

PROJECT MANAGER:  
**BILL CREWE**

SHEET TITLE:

BUILDING IDENTIFICATION SIGN LOCATIONS

PROJECT NO:  
**CAMPUS/16/32**

DATE:  
**09/27/2016**

SHEET  
**A-1**